



Bristol 2 Litre Clutch & Gearbox Parts List

Engine Type 85, 100, 110

Gearbox Type BWCR

Clutch



GBX1191
Clutch Arm
Adjusting Nut
(for conversion kit)



GBX1157
Clutch Release Bearing
(Standard)



GRB113
Carbon Release Bearing
(Like N440490)



GRB113A
Modern Release
Bearing Conversion
(Replaces GRB113 carbon release)



GBX1138
Clutch Bearing
Conversion Kit
Carbon > Standard



GBX1213
Clutch Bearing
Clip (1)



GBX1161S
7.5" Clutch Plate (Road)
Only fits with GBX1214



GBX1164
8" Clutch Plate (Road)



GBX1163
8.5" Clutch Plate (Road)



GBX1165
8" Clutch Plate (Sports) Helix



GBX1166
8.5" Clutch Plate (Sports) Helix



GBX1167
8.5" Clutch Plate (Sports) AP Racing



GBX1214
7.5" Diaphragm Clutch Cover
(Sports) - carbon bearing



GBX1159H
8" Spring Clutch Cover
(re-conditioned original)*



GBX1160
8"/8.5" Diaphragm Clutch Cover
(Road) - carbon bearing



GBX1161
8"/8.5" Diaphragm Clutch Cover
(Sports/Hillclimb/Sprint) - carbon bearing



GBX1161H
8" Diaphragm Clutch Cover (Sports) - carbon bearing



GRB113B
Clutch Spacer Block
Solve's clearance issues
between the release bearing
and clutch



*Supplied on an exchange basis, surcharges apply
Sports = fast road

Clutch

The clutch kits on this page are for road and track applications.

We can also supply full race clutches to suit your requirements.

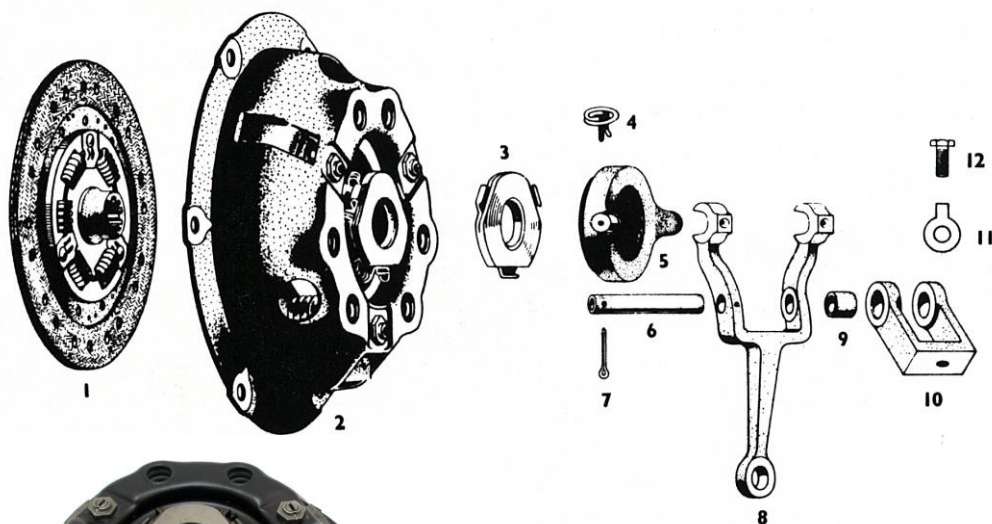

GBX1051 – 8" Standard Road

8" Clutch Kit - Includes:

- GBX1164 8" Clutch Plate
- GBX1159H Original Clutch Cover (Reconditioned exchange) (original cover, standard bearing)



GBX1054 – 8.5" Standard Road

8.5" Clutch Kit - Includes:

- GBX1163 8.5" Clutch Plate
- GBX1159H Original Clutch Cover (Reconditioned exchange) (original cover, standard bearing)



Please Note:

GBX1051 & GBX1054 are the only direct replacement clutches we have available.

All other items listed are modern 3 pin clutches, which require modification of the flywheel for fitment.

GBX1052 – 8" Standard Road

8" Clutch Kit - Includes:

- GBX1164 8" Clutch Plate
- GBX1160 8" Clutch Cover

Replaces original type clutch kit and includes later type cover to replace spring type. (diaphragm cover, carbon bearing)



GBX1057 – 8.5" Fast Road

8.5" Clutch Kit - Includes:

- GBX1167 8.5" Clutch Plate (AP Racing)
- GBX1160 8"/8.5" Clutch Cover (diaphragm cover, carbon bearing)



GBX1059 – 8.5" Race/Sprint/Hillclimb

8.5" Clutch Kit - Includes:

- GBX1161H 8.5" Clutch Cover (Helix)
- GBX1166 8.5" Clutch Plate (Helix) (diaphragm cover, carbon bearing)

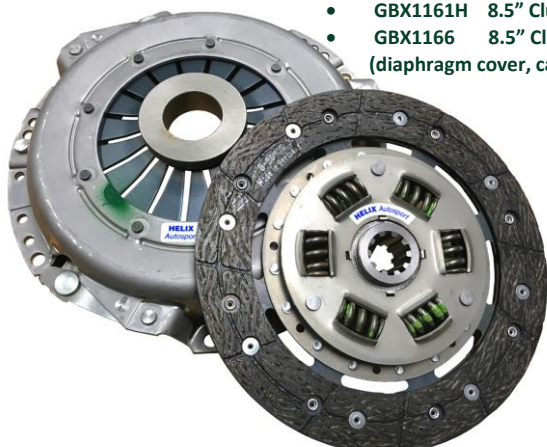

GBX1058 – 8.5" Fast Road/Sprint/Hillclimb/Track Day

8.5" Clutch Kit - Includes:

- GBX1167 8.5" Clutch Plate (AP Racing)
- GBX1161 8"/8.5" Clutch Cover (Heavy Duty) (diaphragm cover, carbon bearing)



Gearbox Casing & Cover

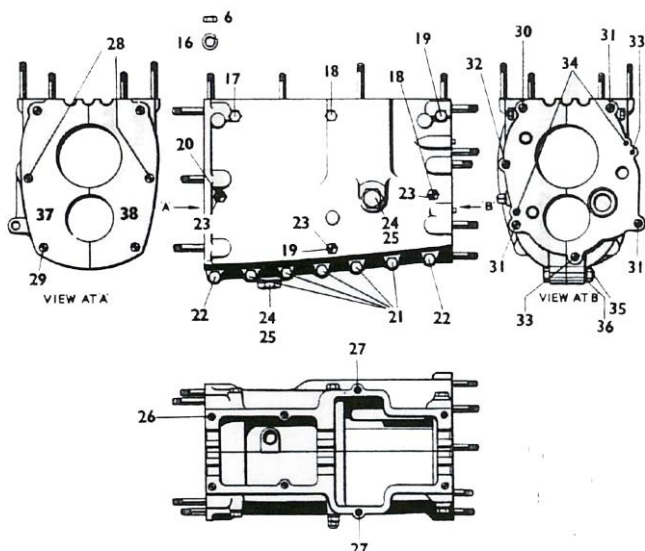
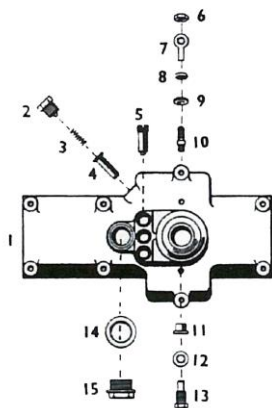

Part No.	Item	Description
N450020	1	Gearbox Cover
N452750	5	Selector Ball Unit - Reverse Marked 'R'
FN.104/L	6	Nut 1/4" BSF
AGS.162/E	12	Spring Washer - Pivot Screw
N451740	13	Pivot Screw - Gear Lever
AGS.585/D	16	Spring Washer
N455750		Copper Washer (under domed nut only)
N455360	28	Stud - Short - Clutch Casing
N455340	29	Stud - Long - Clutch Casing
N455370	30	Stud - Short - Extension Bracket
N455350	31	Stud - Long - Extension Bracket
N455380	32	Stud - Short - Extension Bracket
N455260	33	Stud - Long - Extension Bracket
FN.105/L	35	Nut 5/16" BSF
AGS.585/E	36	Spring Washer
GBX1208		Remote Gear Lever
GBX1207		Extra gear levers, made to suit

GBX1208 Remote Gear Lever

GBX1207 Extra gear levers can be made to suit.

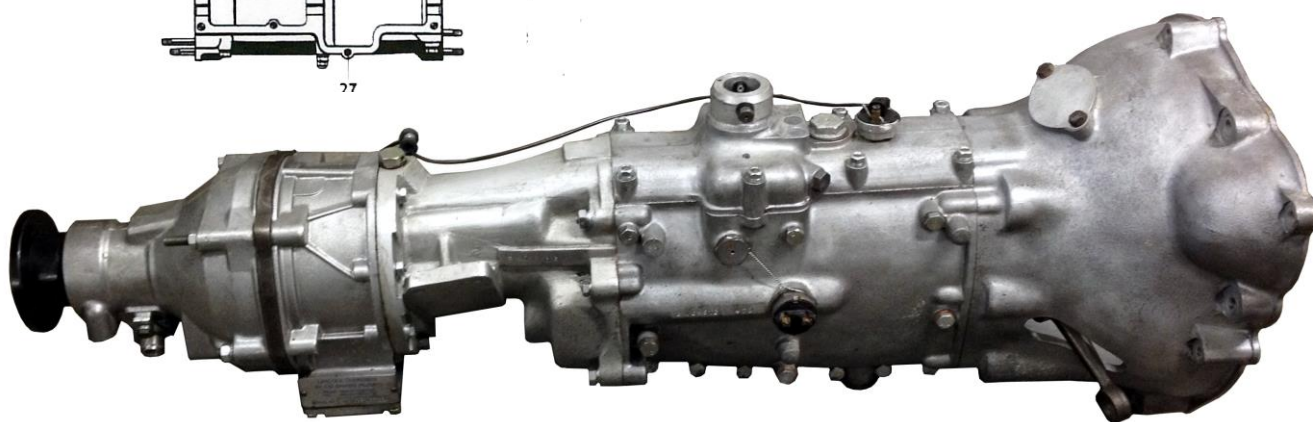

Aftermarket 'J Type' Overdrive fitted with long extension unit



Bristol 400, restored and prepared by INRacing, shown here completing the Mille Miglia, May 2016

Gearbox

Part No.	Item	Description
N451010	14	Speedo Drive Union
N454240	15	Gear (Speedo 2 nd Redn. Driven)
N451890	16	Cover (Speedo 1 st Redn. Shaft)
N454230	17	Worm
N451350	18	Gear (Speedo 1 st Redn. Driven)
N451170	21	Gear Box Extension Unit (Second hand)
N450890	25	End Plate
GBX1217	2+22+23	Gearbox Gasket Set
GBX1210	27	Gearbox Mounting
AGS.585/E36		Spring Washer
37H1901		J-Type Overdrive Main Case > Adapter Plate Gasket
502556		A-Type Overdrive End Plate Gasket
GBX1218		Gearbox Bearing Set (Overdrive models) – 7 Bearings <i>No output shaft bearing required</i>
GBX1219		Gearbox Bearing Set (Models with no overdrive) – 8 Bearings

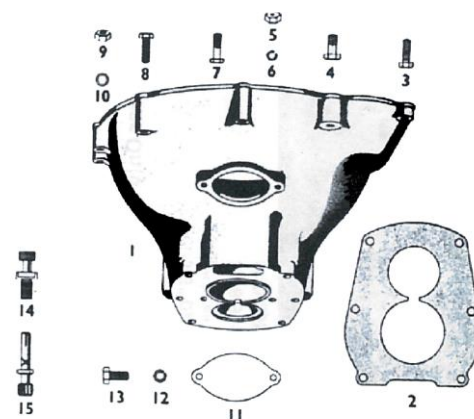

Gearbox parts can be supplied, please contact us with your requirements,
Including overdrive units and gear shift remotes.

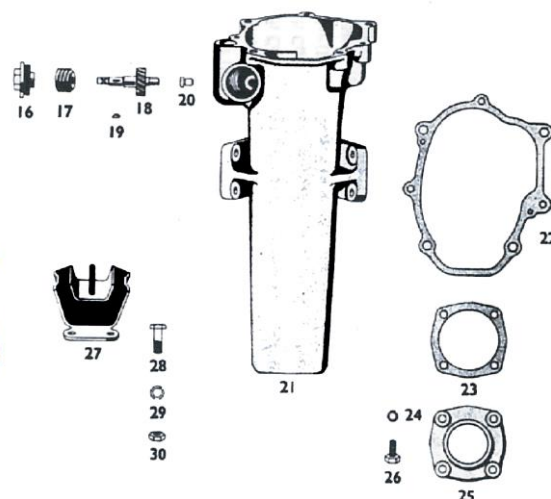

Original 'A Type' Overdrive fitted with short extension unit

GBX1210
Gearbox Mounting



GBX1218
A Type Original Overdrive Gearbox Bearing Set



ENG1302
Reverse Lock Out Mechanism



GBX1219
Gearbox Bearing Set (No Overdrive)

GBX1220
J Type Aftermarket Overdrive Gearbox Bearing Set

Main Shaft



GBX1215
1st / 2nd Sliding Hub Gear Assembly



GBX1216
3rd / 4th Sliding Hub Gear Assembly



GBX235
1st Gear (Pair) 15/32 (Short)

GBX236
1st Gear (Pair) 16/32 (Long)



GBX237
2nd Gear (Pair) 27/21



GBX238
3rd Gear (Pair) 24/23



GBX239
4th Gear (Pair) 26/21



Woodruff Keys



GBX1209
Shifting Plate Set (6)

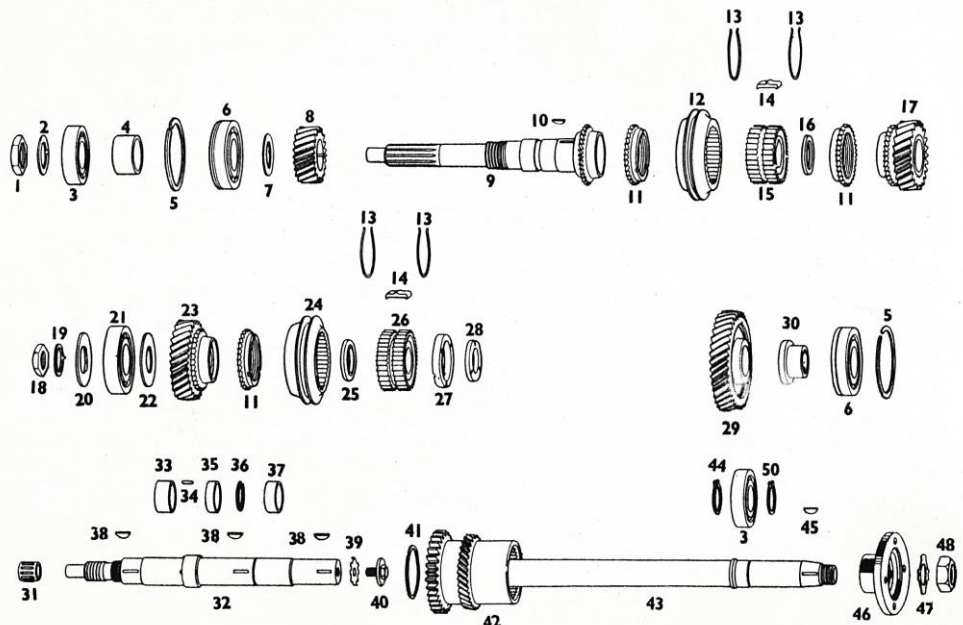

Part No.	Item	Description
N452390	3	Front Drive Shaft Bearing
N451550	6	Drive Shaft Bearing
GBX225	9	Input Shaft (N453680)
GBX1212	11	Gearbox Synchro Ring (Like N455500)
N453020	13	Retaining Ring
GBX1209	14	Shifting Plate Set (6) (N453030)
N452420	21	Centre Main Shaft Bearing
GBX237	23	2 nd Gear (Pair) 27/21 (N453540 + N450270)
GBX238	17	3 rd Gear (Pair) 24/23 (N453570 + N453460)
GBX239	8	4 th Gear (Pair) 26/21 (N453440 + N453430)
GBX1216	12 + 15	3 rd / 4 th Gear Hub Assy (N453610 + N453600) (Not sold separately)
GBX1215	24 + 26	1 st / 2 nd Gear Hub Assy (N453550 + N453590) (Not sold separately)
GBX235	29	1 st Gear / Layshaft 15/32 (Pair) (Short 1 st gear) (N453780 + N453200)
GBX236	29	1 st Gear / Layshaft 16/32 (Pair) (Long 1 st gear) (N453780 + N453200)
N450520	31	Main Shaft Needle Roller Bearing
GBX1032	32	Gear-Box Main Shaft (N453000)
N452410	34	Needle Roller (1)
N453220	38	Woodruff Key (Each)
N451360	42	Hub, Reverse and Speedo Unit
N450370	43	Extension Shaft (Second hand) – Use No.3 Bearing on this shaft
N480051	45	Woodruff Key (Each)
N704112	46	Companion Flange (Second hand)

INR Close Ratio Gear Sets

GBX230 Close Ratio 1 – 3 Gear Set with 15/32 1st (2nd + 3rd Gears as standard)
 GBX235 + GBX237 + GBX238
 (N453780 + N453200) (N453540 + N450270) (N453570 + N453460)

GBX231 Close Ratio 1 – 4 Gear Set with 15/32 1st (2nd/3rd/4th Gears as standard)
 GBX235 + GBX237 + GBX238 + GBX239
 (N453780 + N453200) (N453540 + N450270) (N453570 + N453460) (N453440 + N453430)

GBX232 Close Ratio 1 – 3 Gear Set with 16/32 1st (2nd + 3rd Gears as standard)
 GBX236 + GBX237 + GBX238
 (N453780 + N453200) (N453540 + N450270) (N453570 + N453460)

GBX233 Close Ratio 1 – 4 Gear Set with 16/32 1st (2nd/3rd/4th Gears as standard)
 GBX236 + GBX237 + GBX238 + GBX239
 (N453780 + N453200) (N453540 + N450270) (N453570 + N453460) (N453440 + N453430)



GBX1212
Synchro Ring



GBX225
Input Shaft



N450520
Needle Roller Bearing



N453020
Retaining Ring



GBX1032
Main Shaft

Gear Change & Layshaft

3.9:1 Crownwheel & Pinion



GBX1148
Crownwheel & Pinion 3.9:1 (To fit ENV Diffs)

Limited Slip Differential (Plate Type)



GBX1149
LSD Unit

Allows more torque to be transferred to the non slipping/spinning wheel thus increasing traction and corner exit speed. Essential in competition, and of huge benefit to the discerning fast road driver. This well proven multi plate principle is different to other differentials on the market as they are designed to be more progressive. This gives a high performance unit but with no torque steer.



GBX1147
ENV Diff Casing Gasket



ENG1301
AC Ace Diff Hub Flange
Or
Bearing & Seal Carrier

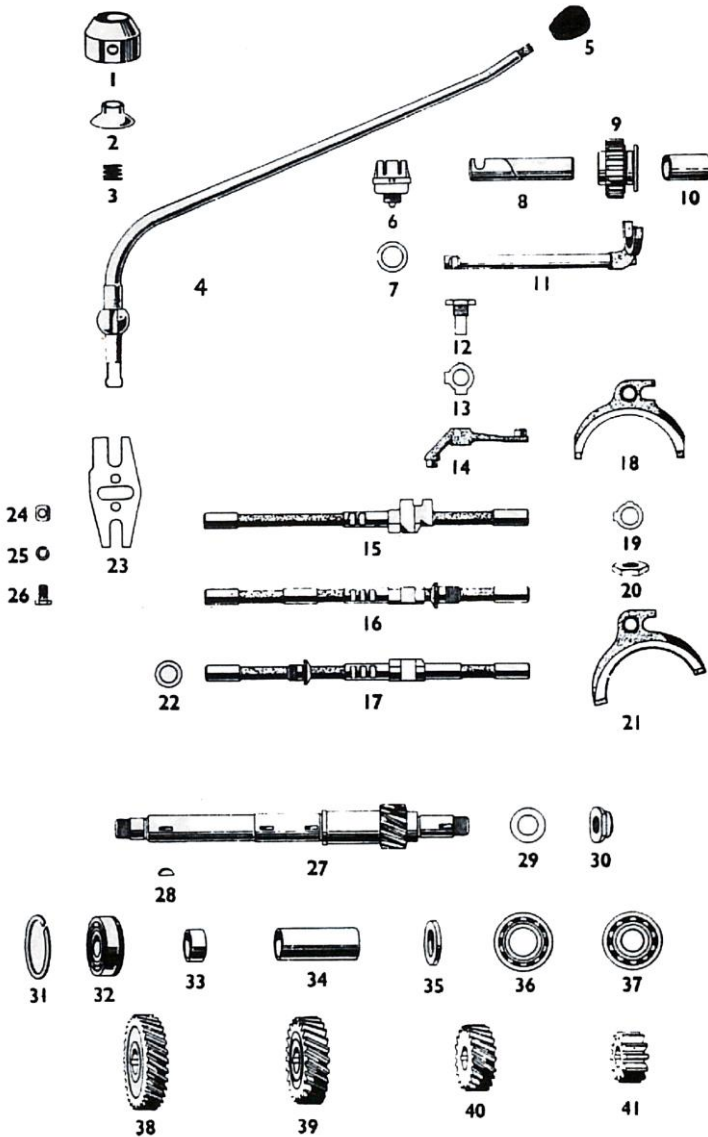

Part No.	Item	Description
N455730	4	Gear Change Lever (Needs machining to suit)
515500-45	6	Lucas Reverse Light Switch
N451000	8	Spindle – Reverse Gear Idler
N451160	9	Reverse Gear – Idler – with Bush
N450360	11	Fork Selector – Reverse
N450860	12	Pivot Pin
GBX1150	14	Fulcrum Lever – Reverse (N450430)
N450180	15	Selector Shaft – Reverse
N453630	16	Selector Shaft 1 st and 2 nd BWCR9
N455610	16	Selector Shaft 1 st and 2 nd BWCR12
N453640	17	Selector Shaft 3 rd and 4 th BWCR9
N455510	17	Selector Shaft 3 rd and 4 th BWCR12
GBX235	27	1 st Gear / Layshaft 15/32 (Pair) (Short 1 st gear) (N453780 + N453200)
GBX236	27	1 st Gear / Layshaft 16/32 (Pair) (Long 1 st gear) (N453780 + N453200)
N450320	30	Layshaft Nut
N451530	32	Front Layshaft Bearing
N450690	33	Distance Piece – Short
N450700	34	Distance Piece – Long
N453730	36	Centre Layshaft Roller Bearing
N452440	37	Rear Layshaft Bearing
GBX239	38	4 th Gear (Pair) 26/21 (N453440 + N453430)
GBX238	39	3 rd Gear (Pair) 24/23 (N453570 + N453460)
GBX237	40	2 nd Gear (Pair) 27/21 (N453540 + N450270)
N455640	41	Layshaft Gear - Reverse
GBX1148		Crownwheel & Pinion
GBX1149		Plate Type Limited Slip Differential (LSD)
ENG1301		Diff Hub Flange